





# Acme Sanitary Ware Co Ltd

Acme Building, 22-28 Nanking Street, Kowloon, Hong Kong  
 Tel: 2388 7171 Fax: 2710 8012  
 E-mail: acme@acmesanitary.com.hk  
 Website: www.acmesanitaryware.com.hk



PROJECT		REF		REV	ITEM CODE	
LOCATION		DATE			PAGE	

## SANITARY WARE SPECIFICATION SHEET

Item Descriptions	GROHE (Germany) "Minta" Chrome plated single lever sink mixer; Nominal flow rate <b>4.9L/Min</b> in WELS Grade 1; Registration No. TM 18-0062	<p>Illustration/ Drawing</p>    
Dimensions	L223 x W140 x H309 mm	
Model	32488000 (Mixer) 64647040 (Aerator)	
Finish	Chrome Plated	
Country of Origin	Portugal	
Manufacturer	GROHE Limited	
Supplier	Acme Sanitary Ware Co. Ltd Mr. Eric Wong/ Mr. Don Yuen	
Contact Tel/Fax	(852) 2388-7171 / (852) 2710-8012	
E-mail	acme@acmesanitary.com.hk	
Website	www.acmesanitary.com.hk	

### Minta Single-lever Sink Mixer 1/2"

U-spout, single hole installation, adjustable flow rate limiter

**GROHE SilkMove®** 46 mm ceramic cartridge,

**GROHE StarLight®** finish

selectable swivel area: 0° / 150° / 360°,

swivel tubular spout flexible connection hoses,

rapid installation system

with 64647040 Insert Faucet Aerator,

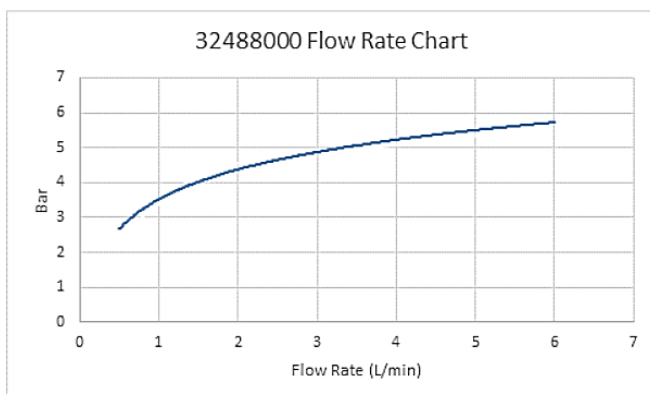

Dynamic flow pressure (kPa)	50	150	250	350	500
Flow rate (l / min )	3.13	4.50	4.88	5.30	5.50

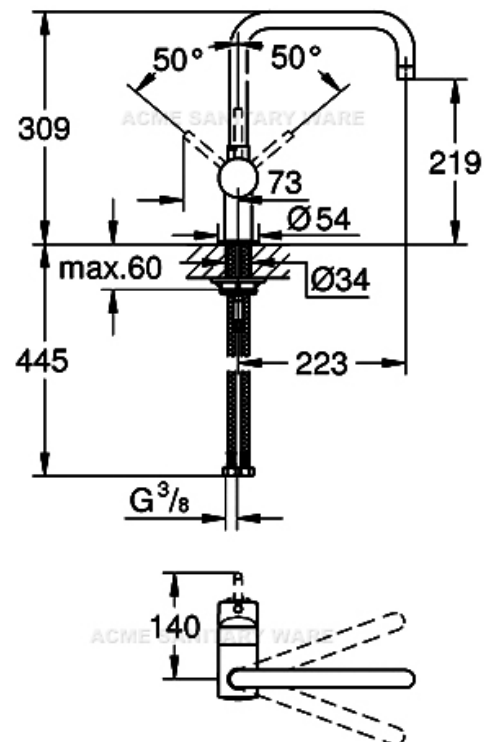

Note: Flexible Hose 406159040

\* All information of the above is for the reference only. No prior notice is made if any changes.

註冊號碼 (Registration No.): TM 18-0062



### 自願參與用水效益標籤計劃 - 水龍頭

## Voluntary Water Efficiency Labelling Scheme - Water Taps



註冊證書

Registration



茲證明

This is to certify that

將下列水龍頭在本計劃內註冊：  
has registered the following water tap under this scheme :

牌子 / Brand	:	GROHE
型號 / Model	:	32488000 + 64647040
種類 / Type	:	Mixing
原產地 / Country or Region Origin	:	Portugal

在用水效益標籤上展示的標誌

Symbolic Presentation on the Water Efficiency Label



滴水點

Water droplet(s)

用水效益級別

Water Efficiency Grade

: 1

耗水量

Water Consumption

: 4.9

公升/分鐘

litres/minute

簽發日期：  
Date of Issue:

16 March 2018



水務署

Water Supplies Department



水務署署長(周世威代行)  
for Director of Water Supplies



總部 Headquarters  
香港灣仔 200 號 200, Queen's Road East, Wan Chai, Hong Kong  
48/F, Imperial Court, 200 Queen's Road East, Wan Chai, Hong Kong

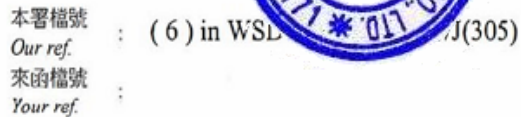

電話 :  
Tel. :  
傳真 : 2824 0578  
Fax. :

19 July 2019



**Approval of "GROHE" Sink Mixer  
(General Acceptance No. C20190369)**

Your letter ref. WRC/2048 dated 27 March 2019 and subsequent submission received by this department on 21 June 2019 refer.

Having considered the test report ref. J23935Ar2 issued on 3 June 2019 by Nutek Systems (HK) Ltd., this Authority accepts that the fitting described below complies with, and its use when correctly installed does not contravene, the Waterworks Ordinance and Regulations.

**Name of Manufacturer:** Grohe AG

Country of Origin: Portugal

**Brand:** Grohe

**Details of Fitting:** 3/8" Single lever sink mixer

**Model:** 32488XXX  
(where the digits "XXX" denote the code of colour)

**Body Markings:** 

**Expiry Date:** 31 January 2024





This Authority hereby permits the use of the above fitting in fresh water plumbing systems subject to full adherence to Waterworks installation requirements. In particular, you are required to draw your customers' attention to the following requirement-

"The cold water supply to the fitting shall be drawn from the same source that supplies the hot water apparatus so as to provide a balanced pressure and to obviate the risk of scalding in the event of a restriction or failure in the water supply."

A condition of this acceptance is that the fitting to be installed shall be replicas of the sample as certified by the testing agent mentioned above and without modifications. This acceptance may be withdrawn at any time if the standard of the fitting installed fails to meet that of the approved sample or if the fitting is found to be unsuitable for use in fresh water plumbing systems.

This acceptance is only applicable to the main body of the fitting, unless otherwise specified.

For the use of the fitting in any project, the General Acceptance Number of this letter must be quoted as a means of identification of acceptance of the fitting by this Authority.

Should you have any enquiries, please contact our Engineer Mr. Terry KUNG at tel. no. 3583 4086.

Yours faithfully,



(CHAN Chung-kun)

for Director of Water Supplies

Encl.

c.c.      WSD 3321/1/82    ] - without catalogue  
            ME/MC            ] - with soft copy only



Department

入境事務大樓 48 樓  
48/F Immigration Tower, 7 Gloucester Road, Wan Chai, Hong Kong

本署檔號 : (4) in WSD 3321/2020 T/J(595/2020)  
Our ref.  
來函檔號 :  
Your ref.

電話 :  
Tel.  
傳真 : 2824 0578  
Fax.

6 July 2020



### Approval of "GROHE" Flexible Hose (General Acceptance No. C20200530)

Your letters ref. WRC/2231 and C-WSD/0605 dated 15 May 2020 and 19 June 2020 respectively refer.

Having considered the test report ref. J24823-1r1 issued on 12 June 2020 by Nutek Systems (HK) Limited, this Authority accepts that the fitting described below complies with, and its use when correctly installed does not contravene, the Waterworks Ordinance and Regulations.

**Name of Manufacturer:** Grohe AG

**Country of Origin:** Italy

**Brand:** Grohe

**Details of Fitting:** Stainless steel braided inlet flexible hose for tap/mixer

**Model:** 406159040

**Size:** Bore diameter: 6mm  
End connection: 3/8"

**Body Markings:**



**Expiry Date:** 23 April 2025

This Authority hereby permits the use of the above fitting in fresh water plumbing systems subject to full adherence to Waterworks installation requirements. In particular, you are required to draw your customers' attention to the following requirement-

"The inlet flexible hose is applied for the water tap or mixer connection only and installed in the fresh water plumbing systems."

A condition of this acceptance is that the fitting to be installed shall be replicas of the sample as certified by the testing agent mentioned above and without modifications. This acceptance may be withdrawn at any time if the standard of the fitting installed fails to meet that of the approved sample or if the fitting is found to be unsuitable for use in fresh water plumbing systems.

For the use of the fitting in any project, the General Acceptance Number of this letter must be quoted as a means of identification of acceptance of the fitting by this Authority.

Should you have any enquiries, please contact our Engineer Mr. Terry KUNG at tel. no. 3583 4086.

Yours faithfully,



(CHAN Chung-kun)

for Director of Water Supplies

Encl.

c.c. WSD 3321/1/82 ] - without catalogue  
ME/MC ] - with soft copy only